

CAT MMC Collet Chucks



T.I.R.: <.00012" or better



Speed: up to 30,000 RPM



Set-up: quick and easy to operate



Coolant-Thru: thru-tool coolant



Milling



Reaming



Drilling



Tapping

- No nut required.
- Slim, compact nose front clamping allows for greater rigidity and precision gripping.
- High concentricity and repeatability.
- Easy-to-use draw-in collet clamping pulled by standard side wrench.
- Pre-balanced for high-speed applications.

Please note that the maximum RPM listed may vary depending on the toolholder shank, weight, balanceability and the G rating.

CAT40

Part Number	Collet Series	Collet Range	Wrench	L	L1	D
CAT40-MMC4-90U	MPK4	1/16 - 3/32" (1 - 4mm)	Wrench-ALLEN6	3.543"	1.181"	0.591"
CAT40-MMC8C-85U-A*	VMK8	1/8 - 3/8" (2 - 8mm)	Wrench-THEX5	3.287"	1.476"	0.787"
CAT40-MMC8C-90U	VMK8	1/8 - 3/8" (2 - 8mm)	Wrench-ALLEN6	3.543"	1.299"	0.787"
CAT40-MMC8C-120U-A*	VMK8	1/8 - 3/8" (2 - 8mm)	Wrench-THEX5	4.724"	1.574"	0.787"
CAT40-MMC8C-120U	VMK8	1/8 - 3/8" (2 - 8mm)	Wrench-ALLEN6	4.724"	1.574"	0.787"
CAT40-MMC12C-90U	VMK12	3/16 - 1/2" (4 - 12mm)	Wrench-ALLEN6	3.543"	1.378"	1.181"
CAT40-MMC12C-120U	VMK12	3/16 - 1/2" (4 - 12mm)	Wrench-ALLEN6	4.724"	2.362"	1.181"

Notes:

- *Wrench included with holder except for A-type holders.
- *"A" denotes collet is drawn directly from the rear of the holder by a bolt.



Wrench-THEX5



Wrench-ALLEN6



Available in **TAPER PLUS**
Dual-taper and flange contact

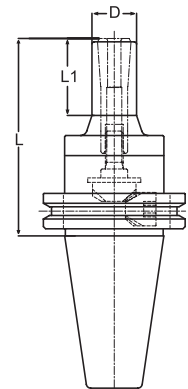

CAT50

Part Number	Collet Series	Collet Range	Wrench	L	L1	D
CAT50-MMC4-105U	MPK4	1/16 - 3/32" (1 - 4mm)	Wrench-ALLEN6	4.134"	1.181"	0.591"
CAT50-MMC8C-105U	VMK8	1/8 - 3/8" (2 - 8mm)	Wrench-ALLEN6	4.134"	1.299"	0.787"
CAT50-MMC8C-135U	VMK8	1/8 - 3/8" (2 - 8mm)	Wrench-ALLEN6	5.315"	1.574"	0.787"
CAT50-MMC8C-165U	VMK8	1/8 - 3/8" (2 - 8mm)	Wrench-ALLEN6	6.496"	1.574"	0.787"
CAT50-MMC12C-105U	VMK12	3/16 - 1/2" (4 - 12mm)	Wrench-ALLEN6	4.134"	1.378"	1.181"
CAT50-MMC12C-135U	VMK12	3/16 - 1/2" (4 - 12mm)	Wrench-ALLEN6	5.315"	2.362"	1.181"
CAT50-MMC12C-165U	VMK12	3/16 - 1/2" (4 - 12mm)	Wrench-ALLEN6	6.496"	2.756"	1.181"

Note: Wrench included with holder.



Wrench-ALLEN6

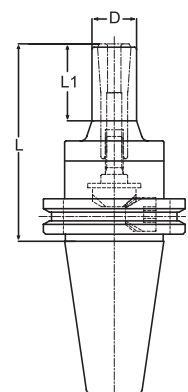

MPK & VMK Collets
Page 82



Tool Jaw
Page 234



Retention Knobs
Page 229

BT MMC Collet Chucks

- No nut required.
- Slim, compact nose front clamping allows for greater rigidity and precision gripping.
- High concentricity and repeatability.
- Easy-to-use draw-in collet clamping pulled by standard side wrench.
- Pre-balanced for high-speed applications.



T.I.R.: <.00012" or better



Speed: up to 30,000 RPM



Set-up: quick and easy to operate



Coolant-Thru: thru-tool coolant



Milling



Reaming



Drilling



Tapping

Please note that the maximum RPM listed in our catalog may vary depending on the toolholder shank, weight, balanceability and the G rating.

BT30

Part Number	Collet Series	Collet Range	Wrench	L	L1	D
BT30-MMC4-105	MPK4	1/16 - 3/32" (1 - 4mm)	Wrench-ALLEN6	4.134"	1.181"	0.591"
BT30-MMC8C-75-A*	VMK8	1/8 - 3/8" (2 - 8mm)	Wrench-THEX5	2.893"	1.476"	0.787"
BT30-MMC12-105	VMK12	3/16 - 1/2" (4 - 12mm)	Wrench-ALLEN6	4.134"	1.378"	1.181"

Notes:

- *Wrench included with holder except for A-type holders.
- *"A" denotes collet is drawn directly from the rear of the holder by a bolt.



Wrench-THEX5



Wrench-ALLEN6



Available in
TAPER PLUS
Dual-taper and flange contact

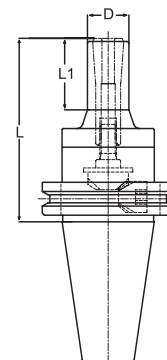

BT40

Part Number	Collet Series	Collet Range	Wrench	L	L1	D
BT40-MMC4-90	MPK4	1/16 - 3/32" (1 - 4mm)	Wrench-ALLEN6	3.543"	1.181"	0.591"
BT40-MMC8C-90	VMK8	1/8 - 3/8" (2 - 8mm)	Wrench-ALLEN6	3.543"	1.417"	0.787"
BT40-MMC8C-120	VMK8	1/8 - 3/8" (2 - 8mm)	Wrench-ALLEN6	4.724"	1.693"	0.787"
BT40-MMC12C-90	VMK12	3/16 - 1/2" (4 - 12mm)	Wrench-ALLEN6	3.543"	1.378"	1.181"
BT40-MMC12C-120	VMK12	3/16 - 1/2" (4 - 12mm)	Wrench-ALLEN6	4.724"	2.362"	1.181"

Note: Wrench included with holder.



Wrench-ALLEN6



Available in
TAPER PLUS
Dual-taper and flange contact

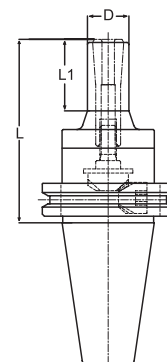

BT50

Part Number	Collet Series	Collet Range	Wrench	L	L1	D
BT50-MMC4-105	MPK4	1/16 - 3/32" (1 - 4mm)	Wrench-ALLEN6	4.134"	1.181"	0.591"
BT50-MMC8C-105	VMK8	1/8 - 3/8" (2 - 8mm)	Wrench-ALLEN6	4.134"	1.417"	0.787"
BT50-MMC8C-135	VMK8	1/8 - 3/8" (2 - 8mm)	Wrench-ALLEN6	5.315"	1.693"	0.787"
BT50-MMC8C-165	VMK8	1/8 - 3/8" (2 - 8mm)	Wrench-ALLEN6	6.496"	1.693"	0.787"
BT50-MMC12C-105	VMK12	3/16 - 1/2" (4 - 12mm)	Wrench-ALLEN6	4.134"	1.378"	1.181"
BT50-MMC12C-135	VMK12	3/16 - 1/2" (4 - 12mm)	Wrench-ALLEN6	5.315"	2.362"	1.181"
BT50-MMC12C-165	VMK12	3/16 - 1/2" (4 - 12mm)	Wrench-ALLEN6	6.496"	2.756"	1.181"

Note: Wrench included with holder.



Wrench-ALLEN6

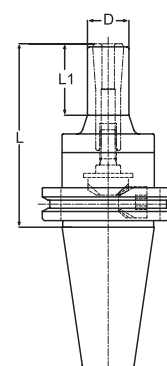

MPK & VMK Collets
Page 82



Tool Jaw
Page 234



Retention Knobs
Page 229

HSK MMC Collet Chucks



T.I.R.: <.00012" or better



Speed: up to 30,000 RPM



Set-up: quick and easy to operate



Coolant-Thru: thru-tool coolant



Milling



Reaming



Drilling



Tapping

- No nut required.
- Slim, compact nose front clamping allows for greater rigidity and precision gripping.
- High concentricity and repeatability.
- Easy-to-use draw-in collet clamping pulled by standard side wrench.
- Pre-balanced for high-speed applications.

Please note that the maximum RPM listed in our catalog may vary depending on the toolholder shank, weight, balanceability and the G rating.

HSK63A/100A

Part Number	Collet Series	Collet Range	Wrench	L	L1	D
HSK63A-MMC8C-115	VMK8	1/8 - 3/8" (2 - 8mm)	Wrench-ALLEN6	4.528"	1.299"	0.787"
HSK63A-MMC12C-110-A*	VMK12	3/16 - 1/2" (4 - 12mm)	Wrench-THEX6	4.331"	1.417"	1.181"
HSK63A-MMC12C-117	VMK12	3/16 - 1/2" (4 - 12mm)	Wrench-ALLEN6	4.606"	1.417"	1.181"
HSK100A-MMC8C-130	VMK8	1/8 - 3/8" (2 - 8mm)	Wrench-ALLEN6	5.118"	1.299"	0.787"
HSK100A-MMC12C-130	VMK12	3/16 - 1/2" (4 - 12mm)	Wrench-ALLEN6	5.118"	1.417"	1.181"

Notes:

- *Wrench included with holder except for A-type holders.
- *"A" denotes collet is drawn directly from the rear of the holder by a bolt.
- Coolant Tube and Wrench are sold separately (HSK63-TUBE/HSK63-WRENCH).



Wrench-THEX5



Wrench-ALLEN6

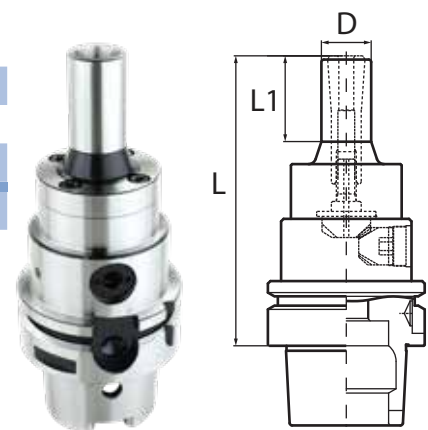

HSK63F

Part Number	Collet Series	Collet Range	Wrench	L	L1	D
HSK63F-MMC8C-127	VMK8	1/8 - 3/8" (2 - 8mm)	Wrench-ALLEN6	5.000"	1.299"	0.787"
HSK63F-MMC12C-129	VMK12	3/16 - 1/2" (4 - 12mm)	Wrench-ALLEN6	5.078"	1.417"	1.181"

Notes:

- Wrench included with holder.
- Coolant tube and wrench are sold separately (HSK63-TUBE/HSK63-WRENCH).



Wrench-ALLEN6

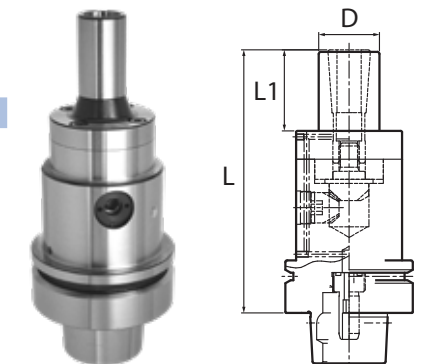

Coolant Tube Wrench for HSK Holders

Part Number	Description
HSK63-WRENCH	Wrench for HSK63 Coolant Tube
HSK100-WRENCH	Wrench for HSK100 Coolant Tube

Note: Coolant tube wrenches are needed to remove or install coolant tubes in HSK toolholders.



Coolant Tube for HSK Holders

Part Number	Description
HSK63-TUBE	Coolant Tube for HSK63 Holders
HSK100-TUBE	Coolant Tube for HSK100 Holders



Straight Shank MMC Collet Chucks

- No nut required.
- Slim, compact nose front clamping allows for greater rigidity and precision gripping.
- High concentricity and repeatability.
- Easy-to-use draw-in collet clamping pulled by standard side wrench.
- Pre-balanced for high-speed applications.



T.I.R.: <.00012" or better



Speed: up to 30,000 RPM



Set-up: quick and easy to operate



Coolant-Thru: thru-tool coolant



Milling



Reaming



Drilling



Tapping

Please note that the maximum RPM listed in our catalog may vary depending on the toolholder shank, weight, balanceability and the G rating.

STRAIGHT SHANK

Part Number	Collet Series	Collet Range	Wrench	L	L1	L2	D
K3/4-MMC8C-100	VMK8	1/8 - 3/8" (2 - 8mm)	Wrench-ALLEN6	3.937"	0.787"	3.149"	0.787"
K1.1/4-MMC8C-122	VMK8	1/8 - 3/8" (2 - 8mm)	Wrench-ALLEN6	4.803"	1.574"	2.637"	0.787"
K1.1/4-MMC8C-160	VMK8	1/8 - 3/8" (2 - 8mm)	Wrench-ALLEN6	6.299"	1.574"	2.637"	0.787"

Note: Wrench included with holder.



Wrench-ALLEN6

